

- Underground information to plan electricity, water and gas supply

Your advantages at a glance

- Platform-independent regarding the operating system and the data base system
- Allows usage of standard service interfaces
- Rule-based data management: allows to merge data from different sources and to define business processes through rules
- Upgrade, analyse and view spatial information with full integration of 2D and 3D data
- Quality assurance and consistency prove throughout several data sources
- Extendable and adaptive data model containing data of buildings and landscapes at various stages of their development as well as data of different development alternatives
- Integration of geology-related data
- Controlled access to the service, layer or feature levels through the administration of access rights on the basis of OpenID and LDAP

FRAUNHOFER IGD: THE WORLD'S LEADING INSTITUTE
FOR APPLIED RESEARCH IN VISUAL COMPUTING

CONTACT:

**Fraunhofer Institute for
Computer Graphics Research IGD**

Competence Center „Spatial Information Management“
Fraunhoferstrasse 5
64283 Darmstadt, Germany

Phone: +49 6151 155-420
info@cityserver3d.de
www.igd.fraunhofer.de/geo

www.cityserver3d.de

CityServer3D





LIFELIKE 3D CITY MODELS

3D computer models will be used more and more for city planning, tourism and knowledge transfer. CityServer3D makes it possible to experience tomorrow's cities using true to life 3D models in real time. CityServer3D's software maintains and integrates two and three dimensional geographic data. CityServer3D creates three dimensional models automatically and performs simulations in the 3D world.

Technology

The CityServer3D Suite consists of a database, a server with numerous interfaces for importing and exporting data, data editing software, and client applications for ongoing development of landscape models. The web viewer sends the data to the user's monitor over the Internet. Fraunhofer IGD is continuously developing the CityServer3D in various research projects according to the customer's specifications.

Applications

The CityServer3D is being successfully used by the municipalities and industry like environment and disaster management, regional planning and marketing, real estate and land management.

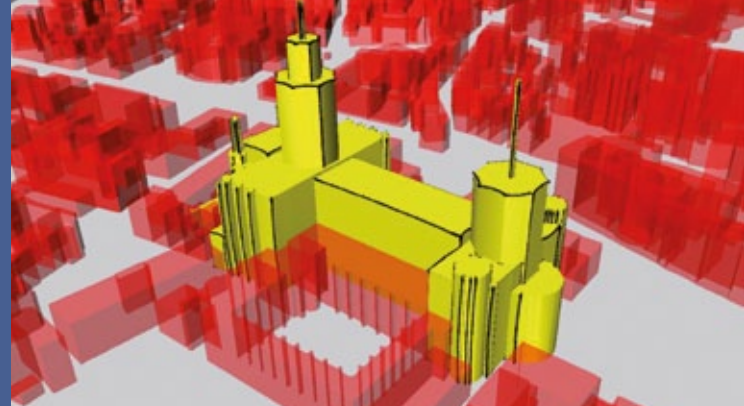
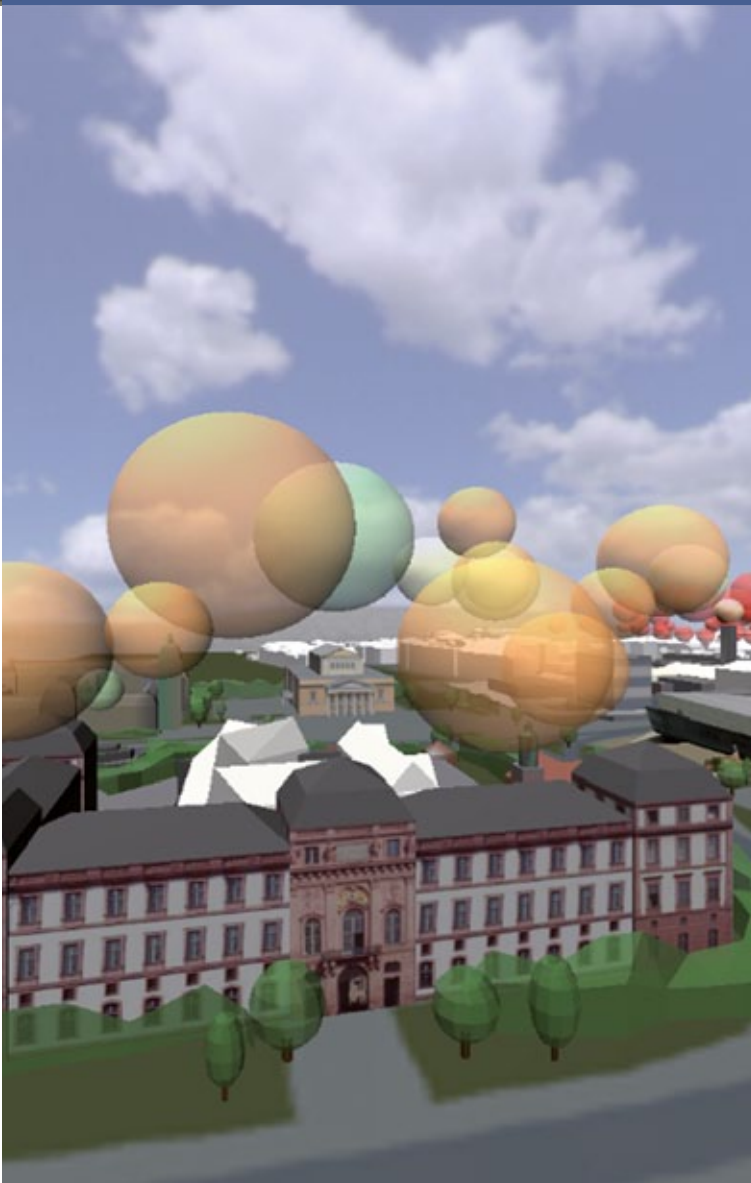

Administrate and plan

» with an always up-to-date city model:

- Individual, sustainable update
- Continuously updated, extended data pool
- Integration in existing Spatial Data Infrastructures (SDI)
- Integration in the existing 3D city model
- Supports standard GIS & CAD formats

Present

» with more information, for higher acceptance, on a better decision basis:

- Upgraded three-dimensional data
- Scenario-related visualisation
- Applicable in tourism as well as region and city marketing
- Integration of multimedia contents such as text, images and videos
- Can be used with mobile end devices
- Supports participation of the citizens in the city development

Analyse

» of data & facts in lifelike scenarios:

- Calculation of sonic diffusion in order to reduce noise emission
- Analysis of the radio wave propagation in order to improve the cover of wireless phone and broadband networks
- Simulation of overflowing water in order to support the disaster control in the compilation of emergency plans